



# Component Guide

2022

ORIGINAL  
HARDI SPARE PARTS

[spareparts.hardi.com](http://spareparts.hardi.com)



# Contents

## CALIBRATION

Field sprayer kit . . . . .	3
Calibrator disc . . . . .	3
Spray Test Paper . . . . .	3

## CONTROL UNITS

M-70 . . . . .	4
BK . . . . .	4
EVC . . . . .	5

## CONTROLLERS & ACCESSORIES

HC 5500 . . . . .	6
-------------------	---

## DROPLEGS

DROP NOZZLE . . . . .	6
-----------------------	---

## HOSE

Pressure hose, Rubber, per metre . . . . .	7
Suction hose, per metre . . . . .	7

## HOSE REELS AND ACCESSORIES

Hose reel 25 m – Complete with brackets and S60 spray gun . . . . .	7
Hose reel 50 m . . . . .	7

## FILTERS

In-Line Filter . . . . .	8
Self-Cleaning Filter . . . . .	8
Floating Filter . . . . .	8

## FITTINGS – S SERIES

Tank flange bulkhead with gasket . . . . .	9
Flange nut . . . . .	9
Plug . . . . .	9
Retaining "U" pin . . . . .	9
Threaded reducer . . . . .	9
Tail straight for pressure hose . . . . .	10
Tail elbow 90 degree for pressure hose . . . . .	10
Tail straight for suction hose . . . . .	10
Tail elbow 90 degree for suction hose . . . . .	10
Manifold Tee . . . . .	10
Manifold joiner . . . . .	10
Manifold reducer . . . . .	10

## FLUSHING NOZZLE

Tank Flushing Nozzle . . . . .	11
--------------------------------	----

## LIQUID MIXING & TRANSFER EQUIPMENT

TurboFiller . . . . .	11
Filling Device . . . . .	11

## PRESSURE GAUGES

Pressure gauges . . . . .	12
---------------------------	----

## HARDI DIAPHRAGM PUMPS

Features: . . . . .	13
HARDI pump 503 . . . . .	14
HARDI pump 603 . . . . .	16
HARDI pump 321 . . . . .	18
HARDI pump 1203 . . . . .	20
HARDI pump 1303 . . . . .	22
HARDI pump 364 . . . . .	24
HARDI pump 464 . . . . .	26

## PUMP KITS

Pump kit / type: . . . . .	28
----------------------------	----

## PUMP GREASE

Pump grease . . . . .	28
-----------------------	----

## SPRAYLINES

Boom tubes with 50 cm spacing and 3/4" end bush . . . . .	30
Caps . . . . .	30
Saddle assemblies . . . . .	30
Nozzle filters . . . . .	30
Nozzle caps and accessories . . . . .	30

## FITTINGS & SPRAYLINES – T25 / T22 FLUID

Fittings . . . . .	31
Fittings . . . . .	31

## SPRAY GUNS

Spray guns . . . . .	32
----------------------	----

## TANKS

NK Tanks . . . . .	32
--------------------	----

## VALVES

Ball valves . . . . .	33
Electric valves . . . . .	33

## Calibration

### Field sprayer kit



A quality kit for calibration is indispensable when using application equipment for quick and easy calculations of application rate, speed, ISO nozzle size and pressure.

- Robust 2 litre jug,
- Spray technique booklet
- Cleaning tool
- Nozzle Calibrator disc

Field sprayer kit, metric .....

Part no.

818492

### Calibrator disc

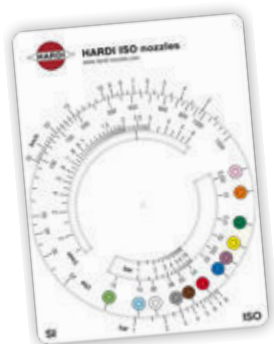

Calibrator disc only .....

- Metric

285802

### Spray Test Paper



A quick and easy way to evaluate drop coverage and penetration. It turns blue upon contact to liquid. Pictogram instructions with drop count indicator are included.

Bag with 50 pieces 2.5 x 7.5 cm paper .....

893211

## Control units

### M-70

Part no.



Control unit with pressure gauge made of hard wearing synthetic materials for long life and chemical resistance.

#### M-70

- Inlet: 1"
- Outlet: 2 x ½"
- Bypass: 1"
- Max. pressure: 15 bar
- Pressure gauge: Dual scale glycerine dampened, 63 mm diameter

841013

### BK



Control unit with section valves and HARDI-MATIC proportional valve. Ideal for field sprayers.

#### Features

- Control of main valve
- Equipped with three valve sections
- Pressure equalization device maintaining the same pressure when the valve is turned off
- Pressure agitation valve for effective agitation
- Easy to read, dual scale pressure gauge
- HARDI-MATIC volumetric valve for constant application rate even with speed variations within the same gear
- Pressure filter with 50 mesh net
- 15 bar safety valve.

#### BK with 3 sections

- Inlet: 1"
- Outlet: 3 x ¾"
- Bypass: 1"
- Pressure agitation: ½"
- Max. pressure: 15 bar
- Pressure gauge: Dual scale glycerine dampened, 63 mm diameter

841902

## EVC

Part no.



Remote controlled units utilize 12 Volt motorized valves (not solenoid) to operate the spray functions. It is the best choice for maximum operator comfort and safety.

### Features

- Remote control of main ON/OFF function
- Three or five section valves
- HARDI-MATIC volumetric pressure regulation valve for constant application rate even with speed variations within the same gear
- Equalization device maintaining the same pressure when section valve is turned off
- Remote control box with five metre of cable
- Pressure agitation valve
- Large, easy to read, stainless steel, glycerine dampened pressure gauge
- Note: The HARDI Self-Cleaning filter or a 15 bar safety valve must also be fitted

### EVC with 3 section .....

- Inlet: 1"
- Outlet: 3/4"
- Bypass: 1"
- Pressure agitation: 1/2"
- Max. pressure: 15 bar
- Pressure gauge: Dual scale, 100 mm diameter

840193





## Controllers & accessories

### HC 5500

Part no.



HARDI Controller for controlling spray application. The large four line display is very informative with both icons and text. It is easy add-on to the HARDI EVC control unit and can be used for GPS applications. HC 5500 can send data to a printer or a computer. The transducers based on solid state electronics.

#### Features

- Full integration with EVC control unit
- Large four line display with back-light
- Preset buttons for most used readouts
- GPS compatible
- Printer compatible
- Only one connection cable to control box

HC 5500 Controller .....	840167
Transducer kit for EVC .....	840169
Tractor mount kit, three pole .....	72050000

## Droplegs

### DROP NOZZLE

Part no.



Snap-on drop-leg designed for spraying low dense crops up under the leaves. It has strong synthetic dropper tube with two nozzle holders. Suitable for 1553 series nozzles (nozzles not included).

#### Features

- Easily adjusted nozzle angles
- Tube length is 60 cm
- Supplied with 40 cm feed hose with SNAP-FIT adapter and 3/8" cap
- Snap Lock mounting bracket for boom

DROP NOZZLE Pack with 5 units .....	834281
-------------------------------------	--------

## Hose

HARDI hose is suitable for working with pesticides. The hose is also available in rolls. **Minimum order quantity 10 meters!**

### Features:

- Reinforced fibre braid pressure hose
- PVC or rubber material
- For pressure hose, working pressure up to 25 bar
- Spiral reinforced suction hose to prevent collapse

### Pressure hose, Rubber, per metre

	Part no.
½" Black, BP 60 .....	927021
¾" Black BP 60 .....	927032
1" Black BP 60 .....	927124
1½" Black, BP 60 .....	92741200

### Suction hose, per metre



¾" Black, BP 20 .....	92738700
1" Black, BP 20 .....	92738800
1¼" Black, BP 18 .....	92738900
1½" Black, BP 18 .....	92739000
2" Black, BP 18 .....	92739100
2½" Black, BP 18 .....	92739200

## Hose reels and accessories

The HARDI hose reel range comes in 25 and 50 metre versions.

There is a range of mounting brackets to suit your needs. See also section on spray guns.

### Features:

- Metallic construction
- Synthetic bushes to ease winding
- Quality braded hose in 3/8" or ½"
- Working pressure up to 25 bar

### Hose reel 25 m – Complete with brackets and S60 spray gun



	Part no.
For MASTER PRO .....	72332800
For MASTER MB & NK .....	72332900
For MASTER HAL .....	72385300

### Hose reel 50 m



Hose reel .....	818377
50 m 3/8" hose .....	835321
50 m ½" hose .....	835332
Model S60 Spray gun .....	843196
<i>See also Spray guns</i>	

# Filters

## In-Line Filter



This bowl type filter is typically fitted to each boom line. It is easy to dismantle due to the radial sealing system making it quick to clean. It is available in different mesh sizes, the higher the number, the finer the mesh.

**Features:**

- 1/2" or 3/4" hose
- Colour coded filter
- 50 (Blue), 80 (Red) or 100 (Yellow) mesh

50 mesh for 1/2" hose .....	845205
80 mesh for 1/2" hose .....	845206
100 mesh for 1/2" hose .....	845207
50 mesh for 3/4" hose .....	845208
80 mesh for 3/4" hose .....	845209
100 mesh for 3/4" hose .....	845210
50 mesh for 3/4" BSP thread .....	845218
80 mesh for 3/4" BSP thread .....	845219
100 mesh for 3/4" BSP thread .....	845220

## Self-Cleaning Filter



The filter minimizes annoying downtime by continually cleaning the filter screen. A by-pass system ensures the filter screen is always clean. The housing has a large screw top for easy maintenance and inspection. Seals are highly resistance to chemicals. A 15 bar safety valve is included.

Self-Cleaning filter, 80 mesh .....	845193
-------------------------------------	--------

## Floating Filter



The specially designed floating suction filter aspirates water 15 cm under the surface thereby avoiding mud and surface weeds. Only clean water is sucked into the tank. Hose tail is 1 1/2".

For trailed sprayers, 8 m of suction hose is standard and for lift it is 5 m.

Float Filter with 1 1/2" hose tail .....	841481
Float Filter for S93 .....	72213600



## Fittings – S series

The “S” series of modular components are professional fittings for liquid systems.

Assembly and disassembly is quick and easy: Simply press in and secure with the “U” pin.

The sealing quality is excellent due to the radial seal system. The wall flanges have a captive gasket to ease installation.

### Features:

- Quick to assemble
- Excellent seal quality due to radial system
- O-ring seals are made of highly chemical resistant material
- No messy gluing or thread tape
- Easy to expand with many combinations
- Flexibility orientation
- High flow capacity (minimal internal restrictions)
- Easy to pull apart and re-usable
- Working pressure up to 15 bar
- Chemical and UV resistant materials (reinforced nylon)

### Tank flange bulkhead with gasket



S40 .....	726462
S53 .....	726463
S67 .....	726464
S93 .....	726465
S93 single side .....	727339

Part no.

### Flange nut



S40 .....	322106
S53 .....	322107
S67 .....	322108
S93 .....	322109

### Plug



S40 .....	726577
S53 .....	726578
S67 .....	726579
S93 .....	726580

### Retaining “U” pin



S40 .....	145994
S53 .....	145995
S67 .....	145996
S93 .....	145997

### Threaded reducer



S40 1/8" female .....	726693
S53 1/2" female .....	726694
S67 1" female .....	726695
S93 2" female .....	727476

### Tail straight for pressure hose



	Part no.
S40 3/8" .....	726554
S53 1/2" .....	726556
S53 3/4" .....	726558
S53 1" .....	726559
S67 1" .....	334231 <i>(use together with O-ring 241973)</i>
S67 1 1/4" .....	334232 <i>(use together with O-ring 241973)</i>
S67 1 1/2" .....	334233 <i>(use together with O-ring 241973)</i>
S93 1 1/2" .....	334886 <i>(use together with O-ring 242092)</i>
S93 2" .....	334234 <i>(use together with O-ring 242092)</i>
S93 2 1/2" .....	334235 <i>(use together with O-ring 242092)</i>

### Tail elbow 90 degree for pressure hose



S40 3/8" .....	726566
S40 1/2" .....	726567
S53 1/2" .....	726568
S53 3/4" .....	726570
S53 1" .....	726571
S67 1" .....	334243 <i>(use together with O-ring 241973)</i>
S67 1 1/4" .....	334244 <i>(use together with O-ring 241973)</i>
S67 1 1/2" .....	334245 <i>(use together with O-ring 241973)</i>
S93 2" .....	334246 <i>(use together with O-ring 242092)</i>
S93 2 1/2" .....	334247 <i>(use together with O-ring 242092)</i>
S93 2 1/2" with 45 degree .....	334882 <i>(use together with O-ring 242092)</i>

### Tail straight for suction hose



S67 1 1/4" .....	334232 <i>(use together with O-ring 241973)</i>
S67 1 1/2" .....	334444 <i>(use together with O-ring 241973)</i>
S93 1 1/2" .....	334304 <i>(use together with O-ring 242092)</i>
S93 2" .....	334426 <i>(use together with O-ring 242092)</i>
S93 2" with 45 degree .....	334881 <i>(use together with O-ring 242092)</i>
S93 2 1/2" .....	334443 <i>(use together with O-ring 242092)</i>

### Tail elbow 90 degree for suction hose



S67 1 1/4" .....	334244 <i>(use together with O-ring 241973)</i>
S67 1 1/2" .....	334445 <i>(use together with O-ring 241973)</i>
S93 1 1/2" .....	334647 <i>(use together with O-ring 242092)</i>
S93 2" .....	334446 <i>(use together with O-ring 242092)</i>
S93 2 1/2" .....	334340 <i>(use together with O-ring 242092)</i>
S93 2 1/2" with 45 degree .....	334883 <i>(use together with O-ring 242092)</i>

### Manifold Tee



S53 .....	322352
S67 .....	322224
S93 .....	334545

### Manifold joiner



S53 .....	72114300
S67 .....	334573 <i>(use together with 2x O-ring 242353)</i>
S93 .....	334572 <i>(use together with 2x O-ring 242092)</i>

### Manifold reducer



S67 - S53 male/female .....	334564 <i>(use together with O-ring 241973)</i>
S93 - S67 male/female .....	728562
S93 - S67 male/male .....	728527

## Flushing Nozzle

A simple and effective method to flush tanks. The rotating nozzle inside the tank flushes the tank surface with a minimal amount of water. A pressure of 4 to 5 bar is optimum for flushing.

### Features:

- One nozzle for lift-mounted sprayers
- Two nozzles trailed sprayers
- Fittings for the rear nozzle on trailed permits easy installation and removal

### Tank Flushing Nozzle

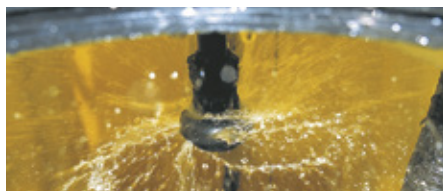

	Part no.
One nozzle .....	834376
Two nozzle .....	834375
One nozzle with 80 litre flush tank .....	833348
One nozzle with manifold .....	834273
Two nozzle with manifold .....	833060

## Liquid mixing & transfer equipment

### TurboFiller



A high capacity venturi system for transferring all types of crop protection chemicals be it liquids, powders or granules to the tank. It consists of a hopper with lid, valve set and cleaning pipe.

### Features:

- Cleaning pipe to wash remaining chemical
- One metre hose on cleaning pipe
- When used, it can be lowered to a natural working height
- Available in 25 and 35 litre versions
- Rotating nozzle with spike for container rinsing

	Part no.
TurboFiller 25 for 1303 pump .....	72595700
TurboFiller 35 for 363 pump .....	72596300

### Filling Device



The equipment utilizes the pump to transfer the liquid.

Two optional suction filters are available. The floating suction filter aspirates water 15 cm under the surface thereby avoiding mud and surface weeds. Only clean water is sucked into the tank.

Hose holder is optional.

### Features:

- 5 m of 1½" suction hose standard
- 3-way valve



Filling Device for 503/603/1203/1303 pump .....	841689
1½" line filter, 30 mesh .....	72576200
Floating suction filter for filling from stream .....	841481
Hose holder .....	833767



## Pressure gauges

The HARDI quality range of easy to read pressure gauges come in 2 sizes.

### Features:

- Easy to read with a split scale
- Dampened, glycerine filled
- Corrosion free stainless steel fittings

### Pressure gauges



0-8/16 bar, Ø 63 mm ¼" bottom fit .....	
0-100/200 PSI, Ø 63 mm ¼" bottom fit .....	
0-8/16 bar, Ø 100 mm ¼" bottom fit .....	
0-8/16 bar, Ø 100 mm ¼" rear fit .....	

Part no.

284270

284277

284831

73843600

## HARDI diaphragm pumps

HARDI diaphragm pumps with their simple construction and robust design are a very reliable pump. Capacities range from 14 to 388 l/min and pressures up to 25 bar.

### Features:

- Simple construction
- Dry sump
- Very easy to maintain and service
- Self-priming
- Can be run dry
- Rotate clockwise/anti-clockwise without damage
- Choice of crankshaft type

### Example

1	2	3	4	5	6	7	8
1303	9.0	- 114 / 540	- 15 bar	- C	- 1¼" / 1"	+	notes

1. Model
2. Stroke in millimetres
3. Capacity in l/min at 0 bar and 540 r/min
4. Normal working r/min
5. Maximum pressure in bar
6. Crankshaft type: S for Spline, C for Conical, Y for Cylindrical
7. Inlet/outlet in inches
8. Notes



## HARDI pump 503

Part no.



### General specifications:

- Compact single diaphragm positive displacement pump.
- Low power consumption.
- Self-priming.
- Can be run dry.
- Can rotate clockwise or anticlockwise.
- Single grease point for lubrication.
- Dry sump to simplify maintenance.
- No special tools needed for maintenance.
- Polyurethane diaphragms and seals.
- Cast iron crankcase and covers.
- 3/4" suction port, 3/4" pressure port.
- Recommended to use HARDI suction and pressure dampers.

<p><b>603/4.0-26/800-15bar-Y-3/4"/3/4"</b> .....</p> <ul style="list-style-type: none"> <li>• Cylindrical shaft, 25 mm / 0.98".</li> <li>• For combustion and electric engine use.</li> <li>• Supplied with narrow base plate.</li> <li>• Normal operating revolutions, 800 r/min.</li> <li>• Maximum pressure, 15 bar / 220 PSI.</li> <li>• Maximum vacuum, 0.85 bar / 12.5 PSI.</li> <li>• Weight, 14.8 kg / 33 lb.</li> </ul>	<p><b>821625</b></p>
<p><b>603/7.0-31/540-15bar-C-3/4"/3/4" + foot</b> .....</p> <ul style="list-style-type: none"> <li>• Tapered shaft.</li> <li>• For tractor use with HARDI transmission shaft.</li> <li>• Supplied with wide base plate.</li> <li>• Normal operating revolutions, 540 r/min.</li> <li>• Maximum pressure, 15 bar / 220 PSI.</li> <li>• Maximum vacuum, 0.91 bar / 13.4 PSI.</li> <li>• Weight, 15.4 kg / 34 lb.</li> </ul>	<p><b>821624</b></p>
<p><b>603/7.0-31/540-15bar-C-3/4"/3/4" + coupling</b> .....</p> <ul style="list-style-type: none"> <li>• Tapered shaft.</li> <li>• With 6-splined coupling for tractor P.T.O. shaft.</li> <li>• Normal operating revolutions, 540 r/min.</li> <li>• Maximum pressure, 15 bar / 220 PSI.</li> <li>• Maximum vacuum, 0.91 bar / 13.4 PSI.</li> <li>• Weight: 16.2 kg / 36 lb.</li> </ul>	<p><b>821623</b></p>



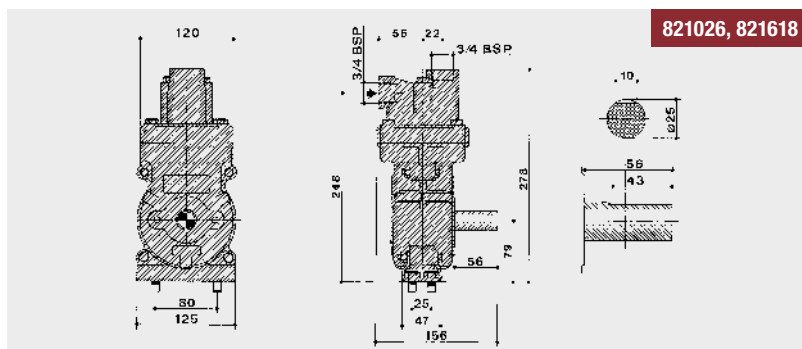

821026, 821618

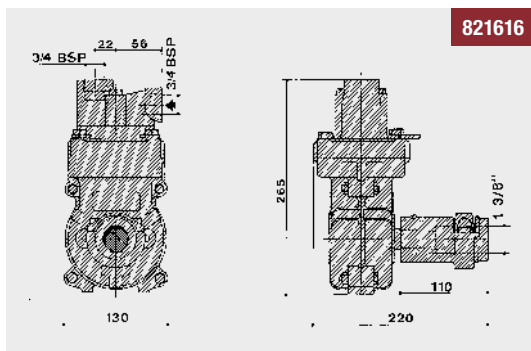

821616

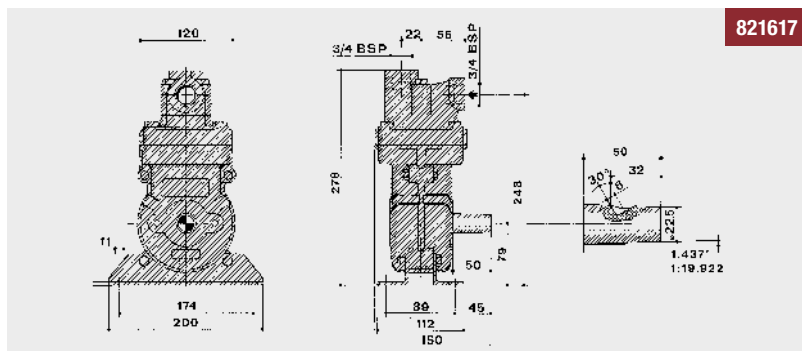

821617

503/4.0	r/min	300		400		500		540	600		700		800		900		1000		
	BAR	l/min	kW	l/min	kW	l/min	kW		l/min	kW	l/min	kW	l/min	kW	l/min	kW	l/min	kW	
	0	5	0.1	7	0.1	9	0.2		12	0.2	13	0.3	14	0.4	16	0.5	17	0.5	
	2	5	0.1	6	0.2	8	0.2		9	0.3	10	0.4	12	0.5	13	0.5	15	0.6	
	4	4	0.2	6	0.2	7	0.3		9	0.4	10	0.4	12	0.5	13	0.6	14	0.7	
	6	4	0.2	5	0.3	7	0.4		9	0.5	10	0.5	12	0.6	13	0.7	14	0.8	
	10	4	0.2	5	0.3	7	0.5		8	0.6	10	0.7	11	0.7	12	0.8	14	0.9	
	15	4	0.3	5	0.4	7	0.6		8	0.7	9	0.8	11	0.9	12	1.0	13	1.1	
	20	4	0.4	5	0.5	7	0.8		8	0.9	9	1.0	10	1.1	12	1.1	13	1.2	
	25	4	0.5	5	0.6	6	1.0		7	1.1	9	1.2	10	1.3	11	1.3	13	1.4	
PSI	gpm	hp	gpm	hp	gpm	hp		gpm	hp	gpm	hp	gpm	hp	gpm	hp	gpm	hp	gpm	hp
0	1.3	0.1	1.8	0.1	2.4	0.3		3.2	0.3	3.4	0.4	3.7	0.5	4.2	0.7	4.5	0.7		
29	1.3	0.1	1.6	0.3	2.1	0.3		2.4	0.4	2.6	0.5	3.2	0.7	3.4	0.7	4.0	0.8		
58	1.1	0.3	1.6	0.3	1.8	0.4		2.4	0.5	2.6	0.5	3.2	0.7	3.4	0.8	3.7	0.9		
88	1.1	0.3	1.3	0.4	1.8	0.5		2.4	0.7	2.6	0.7	3.2	0.8	3.4	0.9	3.7	1.1		
147	1.1	0.3	1.3	0.4	1.8	0.7		2.1	0.8	2.6	0.9	2.9	0.9	3.2	1.1	3.7	1.2		
220	1.1	0.4	1.3	0.5	1.8	0.8		2.1	0.9	2.4	1.1	2.9	1.2	3.2	1.3	3.4	1.5		
294	1.1	0.5	1.3	0.7	1.8	1.1		2.1	1.2	2.4	1.3	2.6	1.5	3.2	1.5	3.4	1.6		
367	1.1	0.7	1.3	0.8	1.6	1.3		1.8	1.5	2.4	1.6	2.6	1.7	2.9	1.7	3.4	1.9		

503/7.0	r/min	300		400		500		540		600		700	
	BAR	l/min	kW	l/min	kW	l/min	kW	l/min	kW	l/min	kW	l/min	kW
	0	9	0.1	12	0.2	15	0.3	16	0.3	17	0.4	20	0.4
	2	8	0.2	11	0.3	14	0.4	15	0.4	16	0.5	19	0.5
	4	8	0.2	11	0.3	14	0.5	15	0.6	16	0.6	19	0.6
	6	8	0.3	11	0.4	13	0.7	14	0.8	16	0.8	19	0.8
	10	8	0.4	10	0.6	13	0.9	14	1.0	16	1.0	19	1.1
	15	8	0.5	10	0.8	13	1.3	14	1.2	16	1.4	18	1.5
	PSI	gpm	hp	gpm	hp	gpm	hp	gpm	hp	gpm	hp	gpm	hp
	0	2.4	0.1	3.2	0.3	4.0	0.4	4.2	0.4	4.5	0.5	5.3	0.5
29	2.1	0.3	2.9	0.4	3.7	0.5	4.0	0.5	4.2	0.7	5.0	0.7	
58	2.1	0.3	2.9	0.4	3.7	0.7	4.0	0.8	4.2	0.8	5.0	0.8	
88	2.1	0.4	2.9	0.5	3.4	0.9	3.7	1.1	4.2	1.1	5.0	1.1	
147	2.1	0.5	2.6	0.8	3.4	1.2	3.7	1.3	4.2	1.3	5.0	1.5	
220	2.1	0.7	2.6	1.1	3.4	1.7	3.7	1.6	4.2	1.9	4.8	2.0	

**Model/stroke** Pump model and pump stroke in millimetre.  
**r/min** Maximum revolutions per minute is indicated by the highest figure.  
**Bar / PSI** Maximum pressure is indicated by the highest figure.  
**kW / Hp** Power consumption in kilowatt and horsepower.  
**l/min / gpm** Capacity in litres and US gallons per minute at zero suction lift.  
**mm to in** = mm x 0.0394

## HARDI pump 603

Part no.

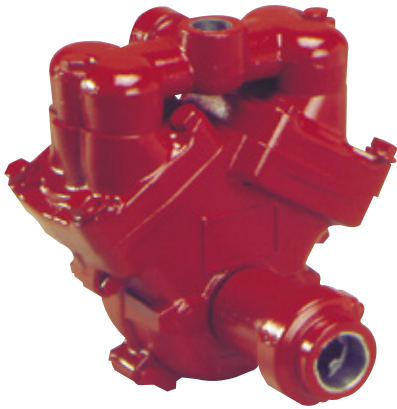

### General specifications:

- Compact two diaphragm positive displacement pump.
- Low power consumption.
- Self-priming.
- Can be run dry.
- Can rotate clockwise or anticlockwise.
- Single grease point for lubrication.
- Dry sump to simplify maintenance.
- No special tools needed for maintenance.
- Polyurethane diaphragms and seals.
- Cast iron crankcase and covers.
- 3/4" suction port, 3/4" pressure port.
- Recommended to use HARDI suction and pressure dampers.

503/4.0-14/800-15bar-Y-3/4"/3/4" + base .....	821618
<ul style="list-style-type: none"> <li>• Cylindrical shaft, 25 mm / 0.98".</li> <li>• For combustion and electric engine use.</li> <li>• Supplied with narrow base plate.</li> <li>• Normal operating revolutions, 800 r/min.</li> <li>• Maximum pressure, 15 bar / 220 PSI.</li> <li>• Maximum vacuum, 0.82 bar / 12.0 PSI.</li> <li>• Weight, 9.0 kg / 20 lb.</li> </ul>	
503/4.0-14/800-25bar-Y-3/4"/3/4" .....	821026
<ul style="list-style-type: none"> <li>• Cylindrical shaft, 25 mm / 0.98".</li> <li>• For combustion and electric engine use.</li> <li>• Supplied with narrow base plate.</li> <li>• Normal operating revolutions, 800 r/min.</li> <li>• Maximum pressure, 25 bar / 367 PSI.</li> <li>• Maximum vacuum, 0.82 bar / 12.0 PSI.</li> <li>• Weight, 9.0 kg / 20 lb</li> </ul>	
503/7.0-16/540-15bar-C-3/4"/3/4" + foot .....	821617
<ul style="list-style-type: none"> <li>• Tapered shaft.</li> <li>• For tractor use with HARDI transmission shaft.</li> <li>• Supplied with wide base plate.</li> <li>• Normal operating revolutions, 540 r/min.</li> <li>• Maximum pressure, 15 bar / 220 PSI.</li> <li>• Maximum vacuum, 0.9 bar / 13.2 PSI.</li> <li>• Weight, 9.2 kg / 20 lb.</li> </ul>	
503/7.0-16/540-15bar-C-3/4"/3/4" + coupling .....	821616
<ul style="list-style-type: none"> <li>• Tapered shaft.</li> <li>• With 6-splined coupling for tractor P.T.O. shaft.</li> <li>• Normal operating revolutions, 540 r/min.</li> <li>• Maximum pressure, 15 bar / 220 PSI.</li> <li>• Maximum vacuum, 0.9 bar / 13.2 PSI.</li> <li>• Weight, 10.3 kg / 23 lb.</li> </ul>	

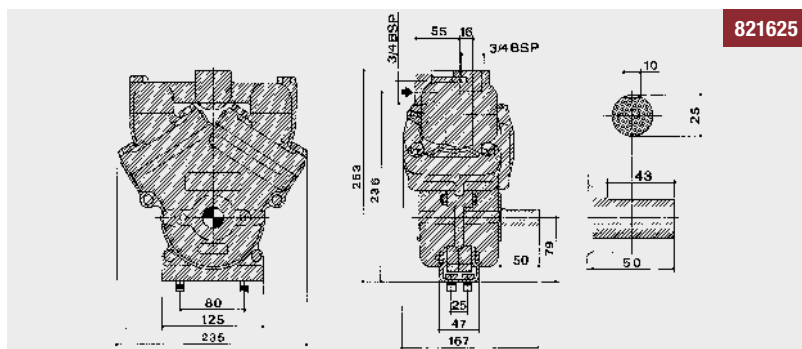
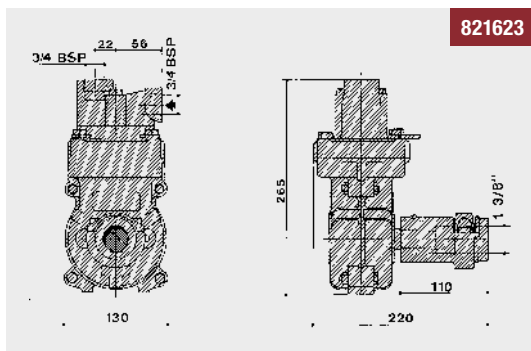
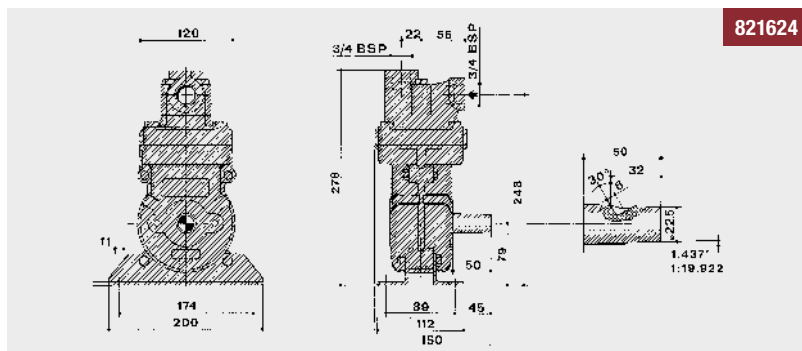
**821625**

**821623**

**821624**

603/4.0	r/min	300		400		500		540	600		700		800		900		1000	
	BAR	l/min	kW	l/min	kW	l/min	kW		l/min	kW	l/min	kW	l/min	kW	l/min	kW	l/min	kW
	0	9	0.1	12	0.2	16	0.2		20	0.3	23	0.4	26	0.5	29	0.6	32	0.7
	<b>2</b>	9	0.2	12	0.2	15	0.3		18	0.4	21	0.5	24	0.6	27	0.7	30	0.8
	<b>4</b>	9	0.2	12	0.3	15	0.4		18	0.5	21	0.6	24	0.7	27	0.8	29	0.9
	<b>6</b>	9	0.3	12	0.4	14	0.5		17	0.6	20	0.7	23	0.8	26	0.9	29	1.1
	<b>10</b>	8	0.4	11	0.5	14	0.6		17	0.8	19	0.9	22	1.1	25	1.2	28	1.4
	<b>15</b>	8	0.5	11	0.6	13	0.8		16	1.0	18	1.2	21	1.3	24	1.5	27	1.7
	PSI	gpm	hp	gpm	hp	gpm	hp		gpm	hp	gpm	hp	gpm	hp	gpm	hp	gpm	hp
	<b>0</b>	2.4	0.1	3.2	0.3	4.2	0.3		5.3	0.4	6.1	0.5	6.9	0.7	7.7	0.8	8.4	0.9
	<b>29</b>	2.4	0.3	3.2	0.3	4.0	0.4		4.8	0.5	5.5	0.7	6.3	0.8	7.1	0.9	7.9	1.1
	<b>58</b>	2.4	0.3	3.2	0.4	4.0	0.5		4.8	0.7	5.5	0.8	6.3	0.9	7.1	1.1	7.7	1.2
	<b>88</b>	2.4	0.4	3.2	0.5	3.7	0.7		4.5	0.8	5.3	0.9	6.1	1.1	6.9	1.2	7.7	1.5
	<b>147</b>	2.1	0.5	2.9	0.7	3.7	0.8		4.5	1.1	5.0	1.2	5.8	1.5	6.6	1.6	7.4	1.9
	<b>220</b>	2.1	0.7	2.9	0.8	3.4	1.1		4.2	1.3	4.8	1.6	5.5	1.7	6.3	2.0	7.1	2.3

603/7.0	r/min	300		400		500		540	600		700		
	BAR	l/min	kW	l/min	kW	l/min	kW	l/min	kW	l/min	kW	l/min	kW
	<b>0</b>	18	0.2	24	0.3	29	0.4	31	0.4	34	0.5	40	0.6
	<b>2</b>	17	0.3	23	0.4	28	0.5	30	0.5	33	0.6	39	0.7
	<b>4</b>	17	0.4	22	0.5	27	0.6	29	0.7	33	0.7	38	0.9
	<b>6</b>	16	0.5	22	0.6	27	0.8	29	0.8	33	0.9	38	1.1
	<b>10</b>	16	0.7	21	0.8	27	1.1	29	1.2	32	1.3	37	1.6
	<b>15</b>	16	1.0	21	1.2	26	1.6	28	1.7	31	1.9	37	2.2
	PSI	gpm	hp	gpm	hp	gpm	hp	gpm	hp	gpm	hp	gpm	hp
	<b>0</b>	4.8	0.3	6.3	0.4	7.7	0.5	8.2	0.5	9.0	0.7	10.6	0.8
	<b>29</b>	4.5	0.4	6.1	0.5	7.4	0.7	7.9	0.7	8.7	0.8	10.3	0.9
	<b>58</b>	4.5	0.5	5.8	0.7	7.1	0.8	7.7	0.9	8.7	0.9	10.0	1.2
	<b>88</b>	4.2	0.7	5.8	0.8	7.1	1.1	7.7	1.1	8.7	1.2	10.0	1.5
	<b>147</b>	4.2	0.9	5.5	1.1	7.1	1.5	7.7	1.6	8.4	1.7	9.8	2.1
	<b>220</b>	4.2	1.3	5.5	1.6	6.9	2.1	7.4	2.3	8.2	2.5	9.8	3.0

**Model/stroke** Pump model and pump stroke in millimetre.  
**r/min** Maximum revolutions per minute is indicated by the highest figure.  
**Bar / PSI** Maximum pressure is indicated by the highest figure.  
**kW / Hp** Power consumption in kilowatt and horsepower.  
**l/min / gpm** Capacity in litres and US gallons per minute at zero suction lift.  
**mm to in** = mm x 0.0394



## HARDI pump 321

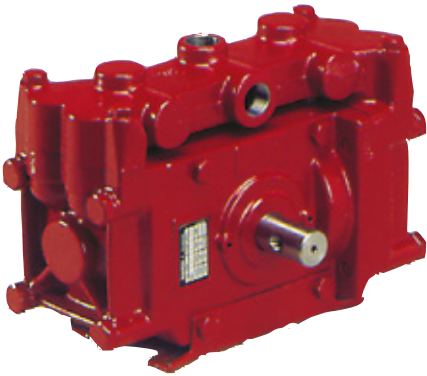

### General specifications

- Compact two diaphragm positive displacement pump.
- Supplied with base plate.
- Self-priming.
- Can be run dry.
- Can rotate clockwise or anticlockwise.
- Single grease point for lubrication.
- Dry sump to simplify maintenance.
- No special tools needed for maintenance.
- Polyurethane diaphragms and seals.
- Cast iron crankcase and covers.
- 3/4" suction port, 3/4" pressure port.
- Recommended to use HARDI suction and pressure dampers.

	Part no.
<b>321/7.0-48/540-25bar-C-3/4"/3/4"</b> .....	<b>821557</b>
• Tapered shaft for tractor use with HARDI transmission shaft.	
• Normal operating revolutions, 540 r/min.	
• Maximum pressure, 25 bar / 367 PSI.	
• Maximum vacuum, 0.82 bar / 12.0 PSI.	
• Weight, 23.6 kg / 52 lb.	
<b>321/7.0-48/540-25bar-C/Y-3/4"/3/4"</b> .....	<b>821560</b>
• Tapered and cylindrical shaft for tractor use with HARDI transmission shaft.	
• Normal operating revolutions, 540 r/min.	
• Maximum pressure, 25 bar / 367 PSI.	
• Maximum vacuum, 0.82 bar / 12.0 PSI.	
• Weight, 24.2kg / 53 lb.	
<b>321/10.0-73/540-20bar-S/S-1"/1" + nitril diap</b> .....	<b>821607</b>
• Spline shaft	
• Normal operating revolutions, 540 r/min.	
• Maximum pressure, 20 bar / 294 PSI.	
• Weight, 23.9 kg / 53 lb.	

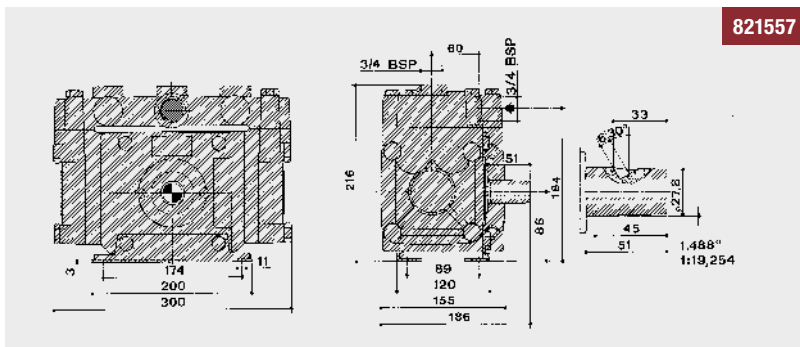
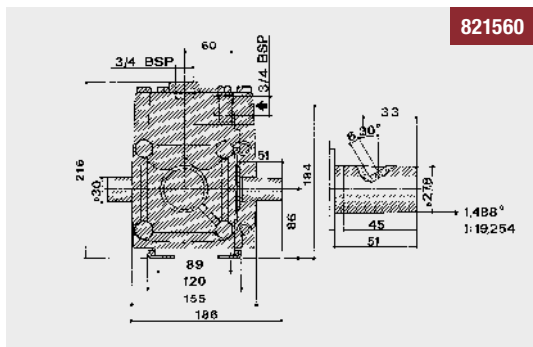

321/7.0	r/min	300		400		500		540		600		700	
	BAR	l/min	kW	l/min	kW	l/min	kW		l/min	kW	l/min	kW	
	0	26	0.2	36	0.3	45	0.4	48	0.5	54	0.6	62	0.7
	2	25	0.3	33	0.4	42	0.6	45	0.7	50	0.8	57	1.0
	4	24	0.4	32	0.6	41	0.8	44	0.9	48	1.1	55	1.3
	6	24	0.6	32	0.8	40	1.1	43	1.2	47	1.4	54	1.6
	10	23	1.0	31	1.2	39	1.6	42	1.7	47	1.9	53	2.2
	15	23	1.5	31	2.0	38	2.2	41	2.3	46	2.5	52	3.0
	20	22	2.3	30	2.6	38	3.2	41	3.2	45	3.4	50	3.7
	25	22	3.0	30	3.3	37	3.6	40	4.0	44	4.3	50	4.8
PSI	gpm	hp	gpm	hp	gpm	hp		gpm	hp	gpm	hp		
0	6.9	0.3	9.5	0.4	11.9	0.5	12.7	0.7	14.3	0.8	16.4	0.9	
29	6.6	0.4	8.7	0.5	11.1	0.8	11.9	0.9	13.2	1.1	15.0	1.3	
58	6.3	0.5	8.4	0.8	10.8	1.1	11.6	1.2	12.7	1.5	14.5	1.7	
88	6.3	0.8	8.4	1.1	10.6	1.5	11.4	1.6	12.4	1.9	14.3	2.1	
147	6.1	1.3	8.2	1.6	10.3	2.1	11.1	2.3	12.4	2.5	14.0	3.0	
220	6.1	2.0	8.2	2.7	10.0	3.0	10.8	3.1	12.1	3.4	13.7	4.0	
294	5.8	3.1	7.9	3.5	10.0	4.3	10.8	4.3	11.9	4.6	13.2	5.0	
367	5.8	4.0	7.9	4.4	9.8	4.8	10.6	5.4	11.6	5.8	13.2	6.4	

**Model/stroke** Pump model and pump stroke in millimetre.  
**r/min** Maximum revolutions per minute is indicated by the highest figure.  
**Bar / PSI** Maximum pressure is indicated by the highest figure.  
**kW / Hp** Power consumption in kilowatt and horsepower.  
**l/min / gpm** Capacity in litres and US gallons per minute at zero suction lift.  
**mm to in** = mm x 0.0394



## HARDI pump 1203

Part no.

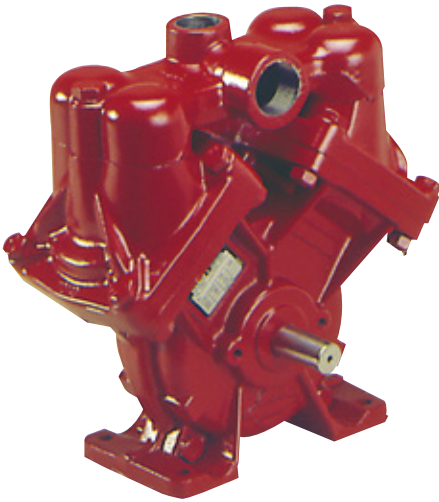

### General specifications

- Two diaphragm positive displacement pump.
- Base plate incorporated in crankcase.
- Self-priming.
- Can be run dry.
- Can rotate clockwise or anticlockwise.
- Single grease point for lubrication.
- Dry sump to simplify maintenance.
- No special tools needed for maintenance.
- Polyurethane diaphragms and seals.
- Stainless steel diaphragm discs and bolts.
- Cast iron crankcase and covers.
- 1 1/4" suction port, 1" pressure port.
- Recommended to use HARDI suction and pressure dampers.

### 1203/6.0-108/1000-15bar-C-1 1/4"/1" .....

821629

- Tapered shaft for tractor use with HARDI transmission shaft.
- Normal operating revolutions, 1000 r/min.
- Maximum pressure, 15 bar / 220 PSI.
- Maximum vacuum, 0.22 bar / 3.2 PSI.
- Weight, 25.5 kg / 56 lb.

### 1203/9.0-99/540-15bar-C-1 1/4"/1" .....

821630

- Tapered shaft for tractor use with HARDI transmission shaft.
- Normal operating revolutions, 540 r/min.
- Maximum pressure, 15 bar / 220 PSI.
- Maximum vacuum, 0.5 bar / 7.4 PSI.
- Weight, 25.5 kg / 56 lb.



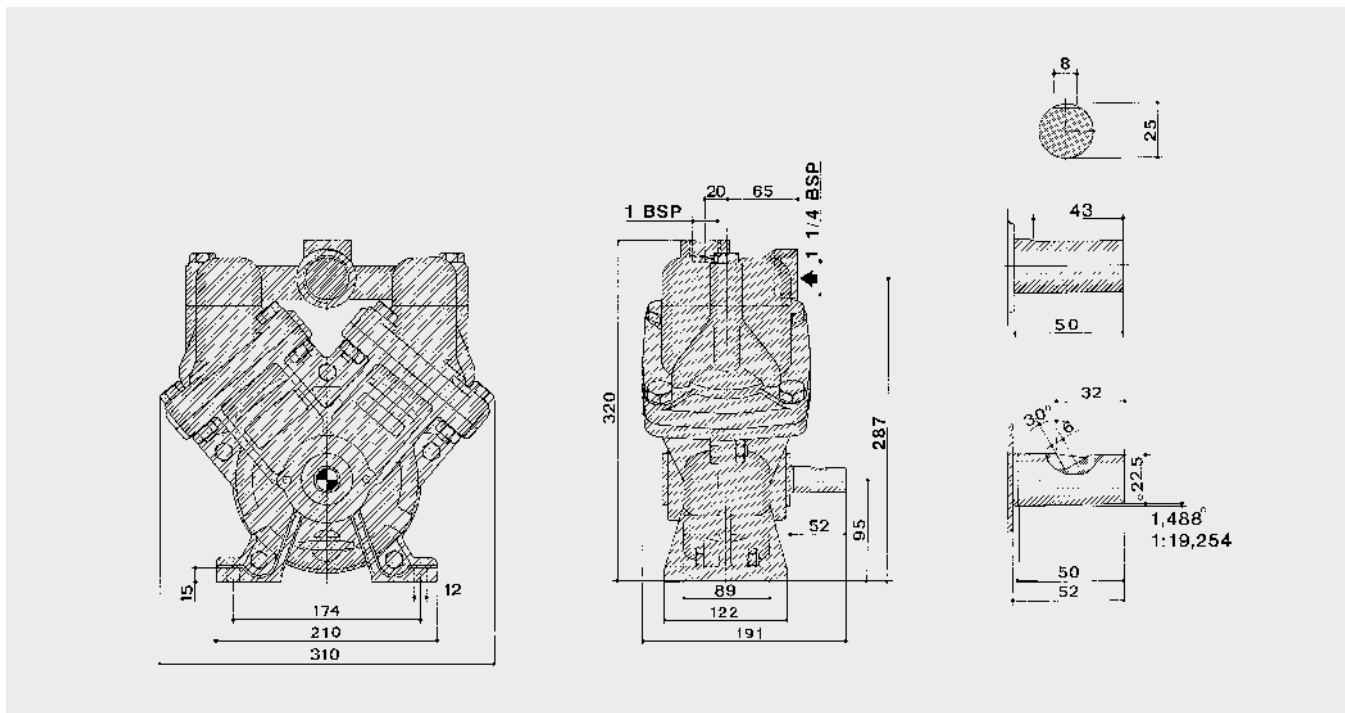

1203/6.0	r/min	300		400		500		540	600		700		800		900		1000		1100		1200			
	BAR	l/min	kW	l/min	kW	l/min	kW		l/min	kW	l/min	kW	l/min	kW	l/min	kW	l/min	kW	l/min	kW	l/min	kW		
	0	36	0.9	47	1.2	58	1.5		71	1.8	83	2.1	93	2.4	101	2.8	108	3.0	115	3.4	128	3.7		
	2	26	1.0	36	1.3	45	1.6		53	1.9	64	2.2	73	2.5	82	2.8	89	3.0	100	3.4	110	3.7		
	4	24	1.0	32	1.3	40	1.6		48	1.9	57	2.2	64	2.5	71	2.8	77	3.1	88	3.5	92	3.7		
	6	23	1.0	31	1.3	39	1.6		46	1.9	53	2.2	60	2.5	68	2.8	74	3.2	82	3.5	87	3.8		
	10	22	1.2	30	1.4	37	1.7		43	2.0	51	2.2	57	2.6	64	2.9	70	3.2	77	3.6	82	3.9		
	15	21	1.3	28	1.5	35	1.8		42	2.1	48	2.4	54	2.8	61	3.2	66	3.5	72	3.9	77	4.1		
	PSI	gpm	hp	gpm	hp	gpm	hp		gpm	hp	gpm	hp	gpm	hp	gpm	hp	gpm	hp	gpm	hp	gpm	hp	gpm	hp
	0	9.5	1.2	12.4	1.6	15.3	2.0		18.7	2.4	21.9	2.8	24.6	3.2	26.7	3.8	28.5	4.0	30.4	4.6	33.8	5.0		
29	6.9	1.3	9.5	1.7	11.9	2.1		14.0	2.5	16.9	3.0	19.3	3.4	21.6	3.8	23.5	4.0	26.4	4.6	29.0	5.0			
58	6.3	1.3	8.4	1.7	10.6	2.1		12.7	2.5	15.0	3.0	16.9	3.4	18.7	3.8	20.3	4.2	23.2	4.7	24.3	5.0			
88	6.1	1.3	8.2	1.7	10.3	2.1		12.1	2.5	14.0	3.0	15.8	3.4	18.0	3.8	19.5	4.3	21.6	4.7	23.0	5.1			
147	5.8	1.6	7.9	1.9	9.8	2.3		11.4	2.7	13.5	3.0	15.0	3.5	16.9	3.9	18.5	4.3	20.3	4.8	21.6	5.2			
220	5.5	1.7	7.4	2.0	9.2	2.4		11.1	2.8	12.7	3.2	14.3	3.8	16.1	4.3	17.4	4.7	19.0	5.2	20.3	5.5			

1203/9.0	r/min	300		400		500		540		600		700	
	BAR	l/min	kW	l/min	kW	l/min	kW	l/min	kW	l/min	kW	l/min	kW
	0	56	0.9	72	1.3	93	1.5	99	1.6	112	1.8	130	2.1
	2	40	1.0	55	1.3	70	1.6	75	1.7	83	1.8	96	2.1
	4	40	1.1	54	1.3	66	1.6	72	1.7	80	1.8	93	2.2
	6	40	1.1	53	1.4	65	1.6	71	1.7	79	1.9	91	2.2
	10	38	1.4	52	1.7	64	1.8	69	1.9	77	2.1	88	2.5
	15	37	1.6	50	2.0	62	2.3	67	2.5	75	2.8	86	3.3
	PSI	gpm	hp	gpm	hp	gpm	hp	gpm	hp	gpm	hp	gpm	hp
	0	14.8	1.2	19.0	1.7	24.6	2.0	26.1	2.1	29.6	2.4	34.3	2.8
29	10.6	1.3	14.5	1.7	18.5	2.1	19.8	2.3	21.9	2.4	25.3	2.8	
58	10.6	1.5	14.3	1.7	17.4	2.1	19.0	2.3	21.1	2.4	24.6	3.0	
88	10.6	1.5	14.0	1.9	17.2	2.1	18.7	2.3	20.9	2.5	24.0	3.0	
147	10.0	1.9	13.7	2.3	16.9	2.4	18.2	2.5	20.3	2.8	23.2	3.4	
220	9.8	2.1	13.2	2.7	16.4	3.1	17.7	3.4	19.8	3.8	22.7	4.4	

**Model/stroke** Pump model and pump stroke in millimetre.  
**r/min** Maximum revolutions per minute is indicated by the highest figure.  
**Bar / PSI** Maximum pressure is indicated by the highest figure.  
**kW / Hp** Power consumption in kilowatt and horsepower.  
**l/min / gpm** Capacity in litres and US gallons per minute at zero suction lift.  
**mm to in** = mm x 0.0394



## HARDI pump 1303

Part no.

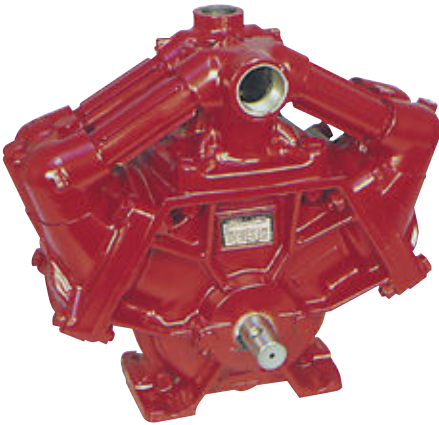

### General specifications

- Three diaphragm positive displacement pump
- Base plate incorporated in crankcase
- Self-priming
- Can be run dry
- Can rotate clockwise or anticlockwise
- Three grease points for lubrication
- Dry sump to simplify maintenance
- No special tools needed for maintenance
- Polyurethane diaphragms and seals.
- Stainless steel diaphragm discs and bolts
- Cast iron crankcase and covers
- 1 1/4" suction port, 1" pressure port
- Recommended to use HARDI suction and pressure dampers

### 1303/6.0-136/1000-15 bar-C-1 1/4"/1" .....

821634

- Tapered shaft for tractor use with HARDI transmission shaft.
- Normal operating revolutions, 1000 r/min.
- Maximum pressure, 15 bar/220 PSI
- Maximum vacuum, 0.26 bar/3.8 PSI
- Weight, 37.7 kg/83 lb

### 1303/9.0-114/540-15 bar-C-1 1/4"/1" .....

821635

- Tapered shaft for tractor use with HARDI transmission shaft
- Normal operating revolutions, 540 r/min
- Maximum pressure, 15 bar/220 PSI
- Maximum vacuum, 0.57 bar/8.4 PSI
- Weight, 37.7 kg/83 lb

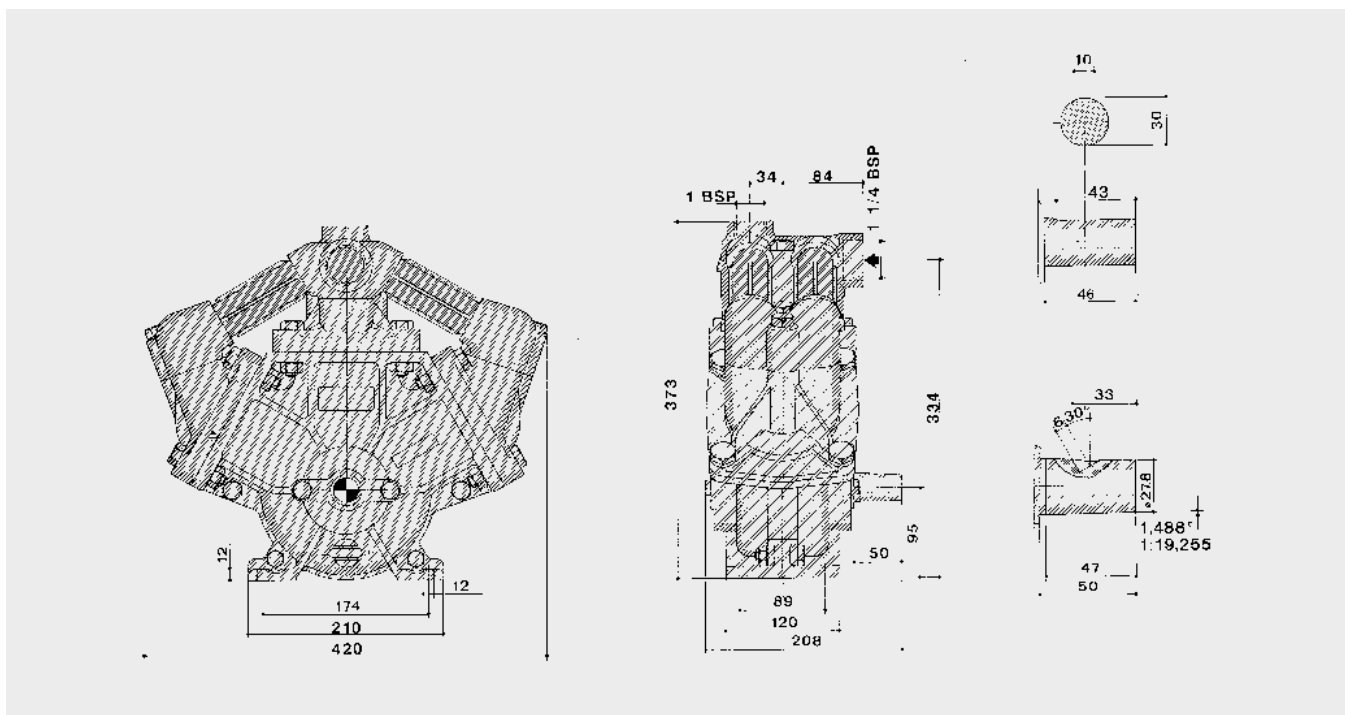

1303/6.0	r/min	300		400		500		540	600		700		800		900		1000		1100		1200			
	BAR	l/min	kW	l/min	kW	l/min	kW		l/min	kW	l/min	kW	l/min	kW	l/min	kW	l/min	kW	l/min	kW	l/min	kW		
	0	41	0.9	54	1.2	70	1.5		82	1.8	94	2.1	106	2.4	122	2.6	136	3.0	151	3.3	165	3.6		
	2	38	0.9	51	1.2	64	1.5		75	1.8	86	2.1	98	2.4	109	2.7	122	3.0	134	3.3	146	3.6		
	4	37	1.0	49	1.3	62	1.6		73	1.9	83	2.2	94	2.4	104	2.7	116	3.1	130	3.3	138	3.6		
	6	36	1.0	48	1.3	60	1.6		70	2.0	81	2.3	91	2.7	101	3.0	113	3.3	124	3.6	133	4.1		
	10	34	1.1	46	1.4	57	1.8		67	2.2	77	2.6	87	3.0	97	3.3	108	3.7	117	4.1	128	4.6		
	15	33	1.4	44	1.7	54	2.2		64	2.7	73	3.1	82	3.6	92	4.1	103	4.5	113	4.9	123	5.3		
	PSI	gpm	hp	gpm	hp	gpm	hp		gpm	hp	gpm	hp	gpm	hp	gpm	hp	gpm	hp	gpm	hp	gpm	hp	gpm	hp
	0	10.8	1.2	14.3	1.6	18.5	2.0		21.6	2.4	24.8	2.8	28.0	3.2	32.2	3.5	35.9	4.0	39.9	4.4	43.6	4.8		
29	10.0	1.2	13.5	1.6	16.9	2.0		19.8	2.4	22.7	2.8	25.9	3.2	28.8	3.6	32.2	4.0	35.4	4.4	38.5	4.8			
58	9.8	1.3	12.9	1.7	16.4	2.1		19.3	2.5	21.9	3.0	24.8	3.2	27.5	3.6	30.6	4.2	34.3	4.4	36.4	4.8			
88	9.5	1.3	12.7	1.7	15.8	2.1		18.5	2.7	21.4	3.1	24.0	3.6	26.7	4.0	29.8	4.4	32.7	4.8	35.1	5.5			
147	9.0	1.5	12.1	1.9	15.0	2.4		17.7	3.0	20.3	3.5	23.0	4.0	25.6	4.4	28.5	5.0	30.9	5.5	33.8	6.2			
220	8.7	1.9	11.6	2.3	14.3	3.0		16.9	3.6	19.3	4.2	21.6	4.8	24.3	5.5	27.2	6.0	29.8	6.6	32.5	7.1			

1303/9.0	r/min	300		400		500		540		600		700	
	BAR	l/min	kW	l/min	kW	l/min	kW	l/min	kW	l/min	kW	l/min	kW
	0	63	0.9	84	1.2	103	1.5	114	1.6	125	1.8	144	2.1
	2	61	0.9	81	1.2	100	1.5	107	1.7	120	1.9	137	2.1
	4	59	0.9	79	1.3	97	1.6	104	1.7	117	1.9	133	2.2
	6	58	1.0	78	1.3	96	1.7	102	1.8	115	2.1	131	2.4
	10	56	1.3	76	1.8	94	2.3	100	2.5	111	2.7	126	3.2
	15	55	1.8	74	2.4	92	3.0	98	3.3	108	3.8	123	4.4
	PSI	gpm	hp	gpm	hp	gpm	hp	gpm	hp	gpm	hp	gpm	hp
	0	16.6	1.2	22.2	1.6	27.2	2.0	30.1	2.1	33.0	2.4	38.0	2.8
29	16.1	1.2	21.4	1.6	26.4	2.0	28.2	2.3	31.7	2.5	36.2	2.8	
58	15.6	1.2	20.9	1.7	25.6	2.1	27.5	2.3	30.9	2.5	35.1	3.0	
88	15.3	1.3	20.6	1.7	25.3	2.3	26.9	2.4	30.4	2.8	34.6	3.2	
147	14.8	1.7	20.1	2.4	24.8	3.1	26.4	3.4	29.3	3.6	33.3	4.3	
220	14.5	2.4	19.5	3.2	24.3	4.0	25.9	4.4	28.5	5.1	32.5	5.9	

**Model/stroke** Pump model and pump stroke in millimetre.  
**r/min** Maximum revolutions per minute is indicated by the highest figure.  
**Bar / PSI** Maximum pressure is indicated by the highest figure.  
**kW / Hp** Power consumption in kilowatt and horsepower.  
**l/min / gpm** Capacity in litres and US gallons per minute at zero suction lift.  
**mm to in** = mm x 0.0394

## HARDI pump 364

Part no.



### General specifications

- Six diaphragm positive displacement radial pump with base plate.
- Self-priming.
- Can be run dry.
- Can rotate clockwise or anticlockwise.
- One grease point for lubrication.
- Dry sump to simplify maintenance.
- No special tools needed for maintenance.
- Polyurethane diaphragms and seals.
- Cast iron crankcase and covers.
- Stainless steel bolts and plates for diaphragms.
- 1½" suction port, 1¼" pressure port.
- Hydraulic drive kit available.

<p><b>364/5.5-185/1000-15bar-S-1½"/1¼"+ 21 spline</b> .....</p> <ul style="list-style-type: none"> <li>• 21-splined 13/8" shaft, for tractor use.</li> <li>• Normal operating revolutions, 1000 r/min.</li> <li>• Maximum pressure, 15 bar / 220 PSI.</li> <li>• Maximum vacuum, 0.48 bar / 7.1 PSI.</li> <li>• Weight, 52.2 kg / 115 lb.</li> </ul>	<p><b>82169500</b></p>
<p><b>364/7.0-140/540-20bar-S/S-1½"/1¼"</b> .....</p> <ul style="list-style-type: none"> <li>• 6-splined 13/8" through shaft, for tractor use.</li> <li>• Normal operating revolutions, 540 r/min.</li> <li>• Maximum pressure, 20 bar / 294 PSI.</li> <li>• Maximum vacuum, 0.54 bar / 7.9 PSI.</li> <li>• Weight, 52.6 kg / 116 lb.</li> </ul>	<p><b>82169900</b></p>
<p><b>364/10.0-194/540-15bar-S-1½"/1¼"</b> .....</p> <ul style="list-style-type: none"> <li>• 6-splined 13/8" shaft, for tractor use.</li> <li>• Normal operating revolutions, 540 r/min.</li> <li>• Maximum pressure, 15 bar / 220 PSI.</li> <li>• Maximum vacuum, 0.64 bar / 9.4 PSI.</li> <li>• Weight, 52.5 kg / 116 lb.</li> </ul>	<p><b>82170000</b></p>
<p><b>364/10.0-194/540-15bar-S/S-1½"/1¼"</b> .....</p> <ul style="list-style-type: none"> <li>• 6-splined 13/8" through shaft, for tractor use.</li> <li>• Normal operating revolutions, 540 r/min.</li> <li>• Maximum pressure, 15 bar / 220 PSI.</li> <li>• Maximum vacuum, 0.64 bar / 9.4 PSI.</li> <li>• Weight, 52.9 kg / 117 lb.</li> </ul>	<p><b>82170300</b></p>
<p><b>364/10.0-194/540-15bar-S-1½"/1¼"</b> .....</p> <ul style="list-style-type: none"> <li>• 6-splined 13/8" shaft, for tractor use.</li> <li>• Normal operating revolutions, 540 r/min.</li> <li>• Maximum pressure, 15 bar / 220 PSI.</li> <li>• Maximum vacuum, 0.64 bar / 9.4 PSI.</li> <li>• Weight, 52.9 kg / 117 lb.</li> </ul>	<p><b>82170400</b></p>

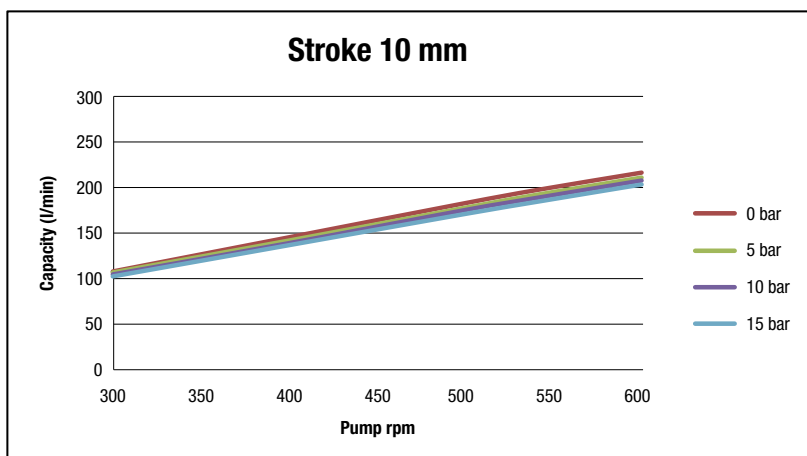
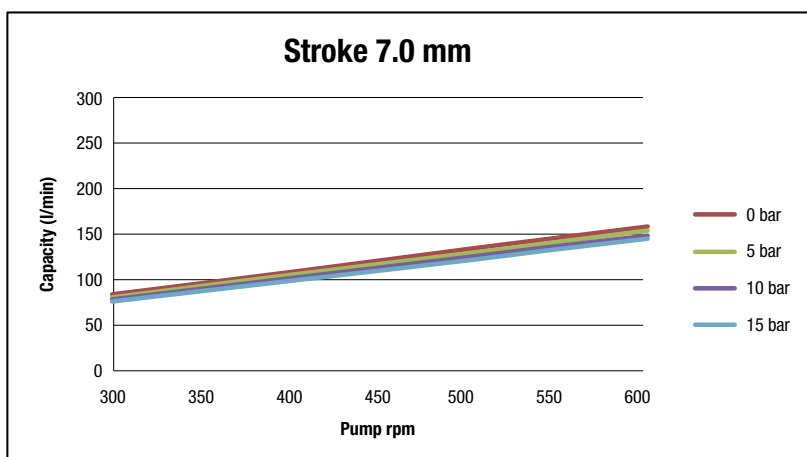
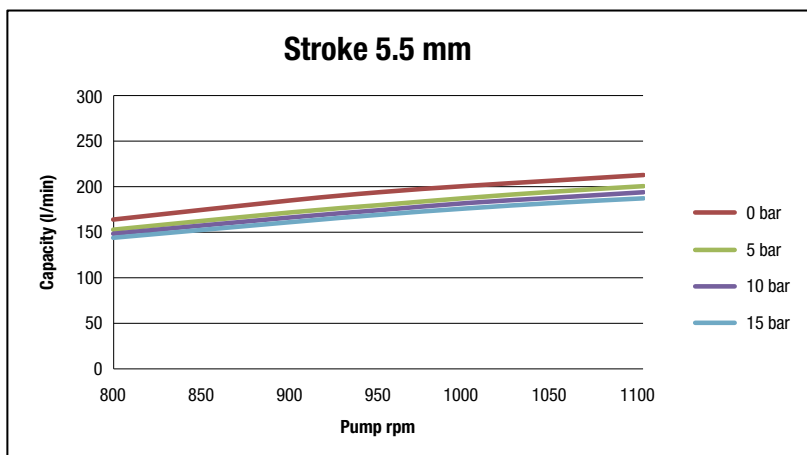

## HARDI pump 464

Part no.



### General specifications

- High capacity six diaphragm positive displacement radial pump with base plate
- Self-priming
- Can be run dry
- Can rotate clockwise or anticlockwise
- One grease point for lubrication
- Dry sump to simplify maintenance
- No special tools needed for maintenance
- Polyurethane diaphragms and seals
- Cast iron crankcase and covers
- Stainless steel bolts and plates for diaphragms
- 2" suction port, 1¼" pressure port
- Hydraulic drive kit available

<b>464/5.5-293/1000-15bar-S/S-2"/1¼"+21 spline</b> ..... • 21-splined 13/8" through shaft, for tractor use • Normal operating revolutions, 1000 r/min • Maximum pressure, 15 bar/220 PSI • Maximum vacuum, 0.40 bar/5.9 PSI • Weight, 66.5 kg/147 lb	82168100
<b>464/5.5-293/1000-15bar-S-2"/1¼"+21 spline</b> ..... • 21-splined 13/8" shaft, for tractor use • Normal operating revolutions, 1000 r/min • Maximum pressure, 15 bar/220 PSI • Maximum vacuum, 0.40 bar/5.9 PSI • Weight, 67.0 kg/148 lb	82168000
<b>464/10.0-280/540-15bar-S-2"/1¼"</b> ..... • 6-splined 13/8" shaft, for tractor use • Normal operating revolutions, 540 r/min • Maximum pressure, 15 bar/220 PSI • Maximum vacuum, 0.58 bar/8.5 PSI • Weight, 66.5 kg/147 lb	82168200
<b>464/10.0-280/540-15bar-S/S-2"/1¼"</b> ..... • 6-splined 13/8" through shaft, for tractor use • Normal operating revolutions, 540 r/min • Maximum pressure, 15 bar/220 PSI • Maximum vacuum, 0.58 bar/8.5 PSI • Weight, 66.9 kg/148 lb	82168300
<b>464/12.0-334/540-15bar-S-2"/1¼"</b> ..... • 6-splined 13/8" shaft, for tractor use • Normal operating revolutions, 540 r/min • Maximum pressure, 15 bar/220 PSI • Maximum vacuum, 0.58 bar/8.5 PSI • Weight, 66.7 kg/147 lb	82168500



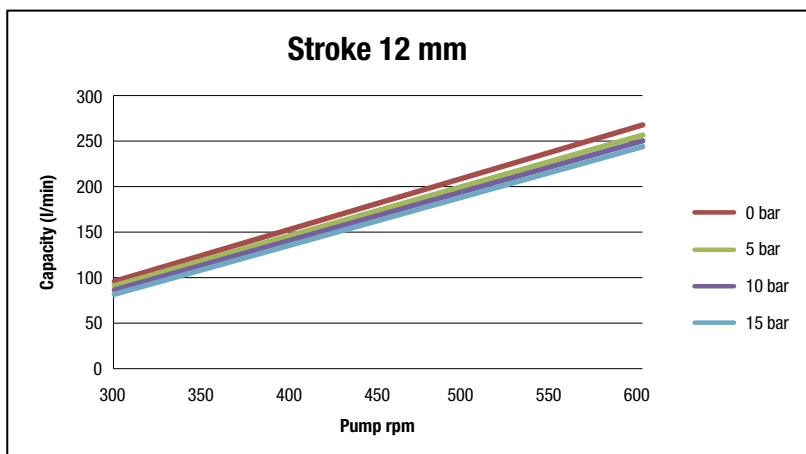
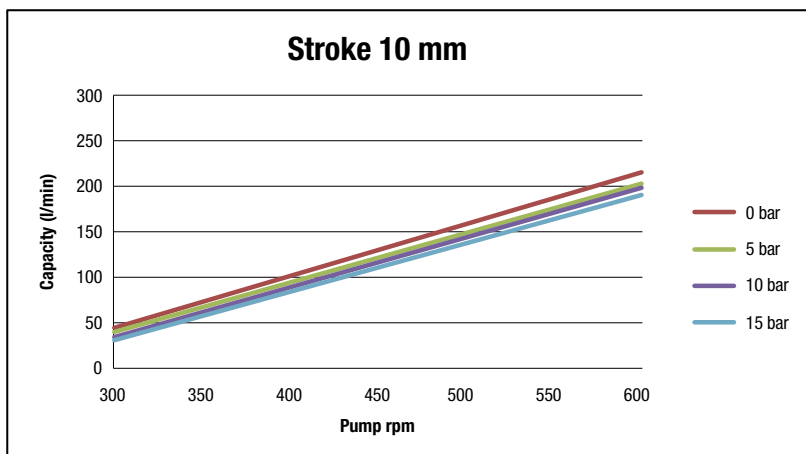
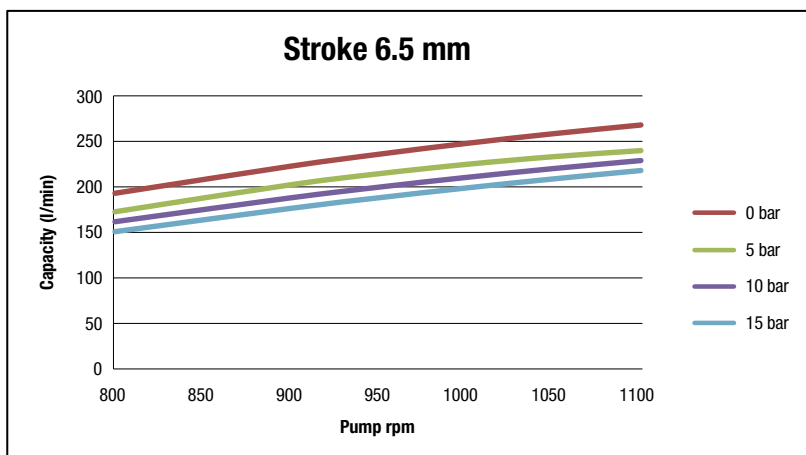
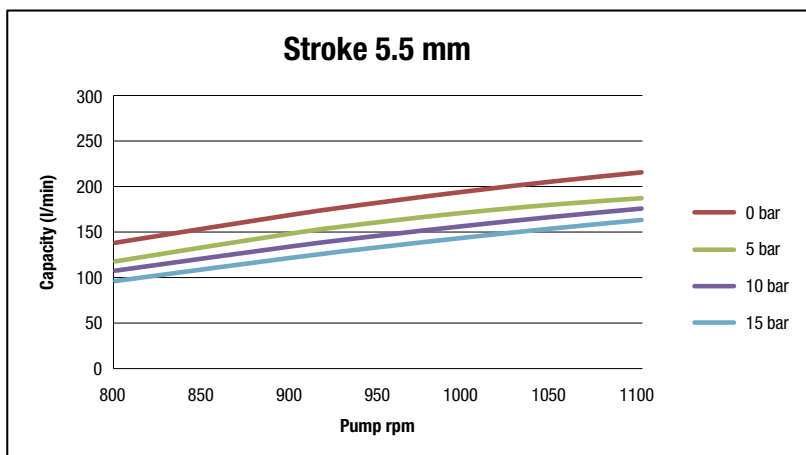



## Pump kits

### All kits include:

- Bolts
- O-rings
- Valves
- Diaphragms

### Pump kit / type:



Pump kit / type:	Part no.
Model 600 .....	75073100
Model 603 .....	75073200
Model 1200/1202 .....	75073300
Model 1203 .....	75073400
Model 1300/1302 .....	75073500
Model 1303 .....	75073600
Model 363 .....	75073700
Model 463 .....	75073900
Model 364 .....	75585900
Model 464 .....	75586000

## Pump grease

### Pump grease



HARDI V550 Lithium pump grease (12 tubes) .....	75586500
---	----------

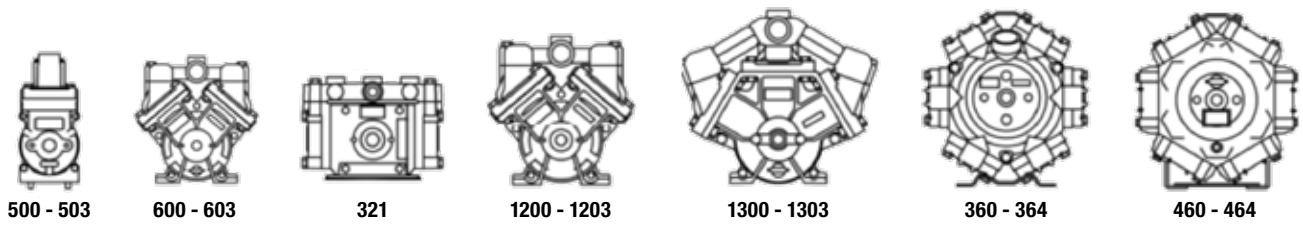

Model	NORMAL DRIFT – 50 HOURS		DIAPHRAGM RENEWAL		NEW BEARINGS	
	Gram total	Ounce total	Gram total	Ounce total	Gram total	Ounce total
500 - 503	6	0.2	40	1.4	60	2.1
600 - 603	10	0.4	60	2.1	100	3.5
321	10	0.4	60	2.1	100	3.5
1200 - 1203	13	0.5	90	3.2	130	4.6
1300 - 1303	3 x 5	3 x 0.2	3 x 35	3 x 1.2	3 x 50	3 x 1.8
360 - 363	50	1.8	350	12.4	500	17.6
364	2 x 30	2 x 1.1	2 x 200	2 x 7.1	2 x 300	2 x 10.6
460 - 463	50	1.8	350	12.4	500	17.6
464	2 x 30	2 x 1.1	2 x 200	2 x 7.1	2 x 300	2 x 10.6

Example

? 10 x = 10 gram  
 10 x ? 30 x = 30 gram



See how to renovate a HARDI pump  
[www.hardi-international.com/pumpkit](http://www.hardi-international.com/pumpkit)

# Spraylines

The extensive range is ideal for the do-it-yourself builder. The materials are chemical and UV light resistant.

## Boom tubes with 50 cm spacing and 3/4" end bush



	Part no.
2-hole .....	612872
3-hole .....	612883
4-hole .....	612894
5-hole .....	612905

## Caps



3/8" .....	320187
1/2" .....	320084
3/4" .....	320283
Boom tube end plug .....	716413
Boom tube 1/2" hose tail .....	726236
Boom tube 3/4" hose tail .....	724621
Boom tube 3/4" threaded .....	720856

## Saddle assemblies



Single with 3/8" screw fitting .....	716037
Single with SNAP-FIT .....	725079
Triple with SNAP-FIT TRIPLET .....	725078

## Nozzle filters



50 mesh (Blue) without seal .....	614366
80 mesh (Red) without seal .....	614367
100 mesh (Yellow) without seal .....	614368
50 mesh (Blue) with seal (for SNAP-FIT) .....	725043
80 mesh (Red) with seal (for SNAP-FIT) .....	725042
100 mesh (Yellow) with seal (for SNAP-FIT) .....	725044

## Nozzle caps and accessories



3/8" .....	320187
3/8" for ISO nozzles (White) .....	321517
SNAP-FIT for hollow cone nozzles .....	334082
SNAP-FIT for flat fan nozzles .....	334083
SNAP-FIT with 3/8" thread .....	322068
Gasket when filter not used .....	242252
Cap to suit "Tee-Jet" bayonet .....	334862
Gasket for "Tee-Jet" bayonet .....	24022901
DUOCAP double nozzle holder .....	28063000
Plugged blank .....	372140
Mounting bracket riser A .....	334873
Bracket angle B .....	334874
Nut C .....	322114
Bolt D .....	322116



## Fittings & Spraylines – T25 / T22 fluid

### Fittings



	Part no.
1/2" Hose – Straight .....	32238700
3/4" Hose – Straight .....	32238800
1" Hose – Straight .....	32238900
1/2" Hose - 45° elbow .....	32240100
3/4" Hose - 45° elbow .....	32240200
1" Hose - 45° elbow .....	32240300
1/2" Hose - 90° elbow .....	32239000
3/4" Hose - 90° elbow .....	32239100
1" Hose - 90° elbow .....	32239200
Plug .....	32239300
Plug – 1/4" BSP .....	39125600
Plug – 1/8" BSP .....	39125500
Union .....	32239500
Union – 1/4" BSP .....	39128700
Cap .....	32239700
Lock ring .....	33523300
Gasket .....	24266200
Clamp 3/4" hose .....	334531

### Fittings

- PP = Plastic / SS = Stainless Steel.



Sprayline, PP, 1 hole .....	34159600
Sprayline, PP, 2 holes .....	34159700
Sprayline, PP, 3 holes .....	34159800
Sprayline, PP, 4 holes .....	34159900
Sprayline, PP, 5 holes .....	34160000
Sprayline, PP, 6 holes .....	34160100
Sprayline, PP, 7 holes .....	34160200
Sprayline, PP, 8 holes .....	34160300
Sprayline, PP, 9 holes .....	34160400



Sprayline, SS, 1 hole .....	15227700
Sprayline, SS, 2 holes .....	15227800
Sprayline, SS, 3 holes .....	15227900
Sprayline, SS, 4 holes .....	15228000
Sprayline, SS, 5 holes .....	15228100
Sprayline, SS, 6 holes .....	15228200
Sprayline, SS, 7 holes .....	15228300
Sprayline, SS, 8 holes .....	15228400
Sprayline, SS, 9 holes .....	15228500



## Spray guns

Top quality, robust spray guns with safety lock OFF to prevent accidental activation. A ceramic 1099-20 nozzle is standard. Model 60 S and 60 L are rugged light weight units for one-handed operation with a comfortable handle and adjustable end piece to alter spray coverage. The L version has a 26 cm extension.

Model 100 is a rugged two-hand operated unit also with adjustable coverage.

### Features:

- Long life ceramic nozzle
- Output is 7.5 litres at 10 bar
- Adjustable spray angle from 5° to 62°
- Up to 12 metre reach
- Lock OFF to prevent accidental spraying
- ½" hose swivel and hose clamp standard

## Spray guns



	Part no.
Model 100, 100 bar max. pressure .....	843195
Model 60 S, 60 bar max. pressure .....	843196
Model 60 L, 60 bar max. pressure .....	843197

## Tanks

The HARDI tanks are made of tough, UV resistant polyethylene.

### Features:

- Complete with lid and fitting
- Basket filter included
- Powder coated frame included

## NK Tanks



	Part no.
NK 200 litre .....	72264700
NK 300 litre .....	72264800
NK 400 litre .....	824197
NK 600 litre .....	824198
NK 800 litre .....	824199

## Valves

The HARDI valves are purpose built for sprayer systems. They are resistant to most pesticides and made from UV resistant, glass reinforced nylon.

### Features:

- Quick to assemble
- Excellent sealing due to radial system
- O-ring seals are made of highly chemical resistant material
- Flexibility orientation
- High flow capacity (minimal internal restrictions)
- Easy to pull apart and re-usable
- Working pressure up to 15 bar for pressure valves

### Ball valves



	Part no.
S67 Two way suction .....	72293700
S93 Two way suction .....	840110
S67 Two way pressure .....	841062
S93 Four way suction .....	72183700
S67 Four way pressure .....	72172300

### Electric valves



S53 – S40 Solenoid .....	262104
Cover .....	334965
S93 – S67 Motor-drive bypass .....	72374300
<i>See Fittings for S series fittings</i>	







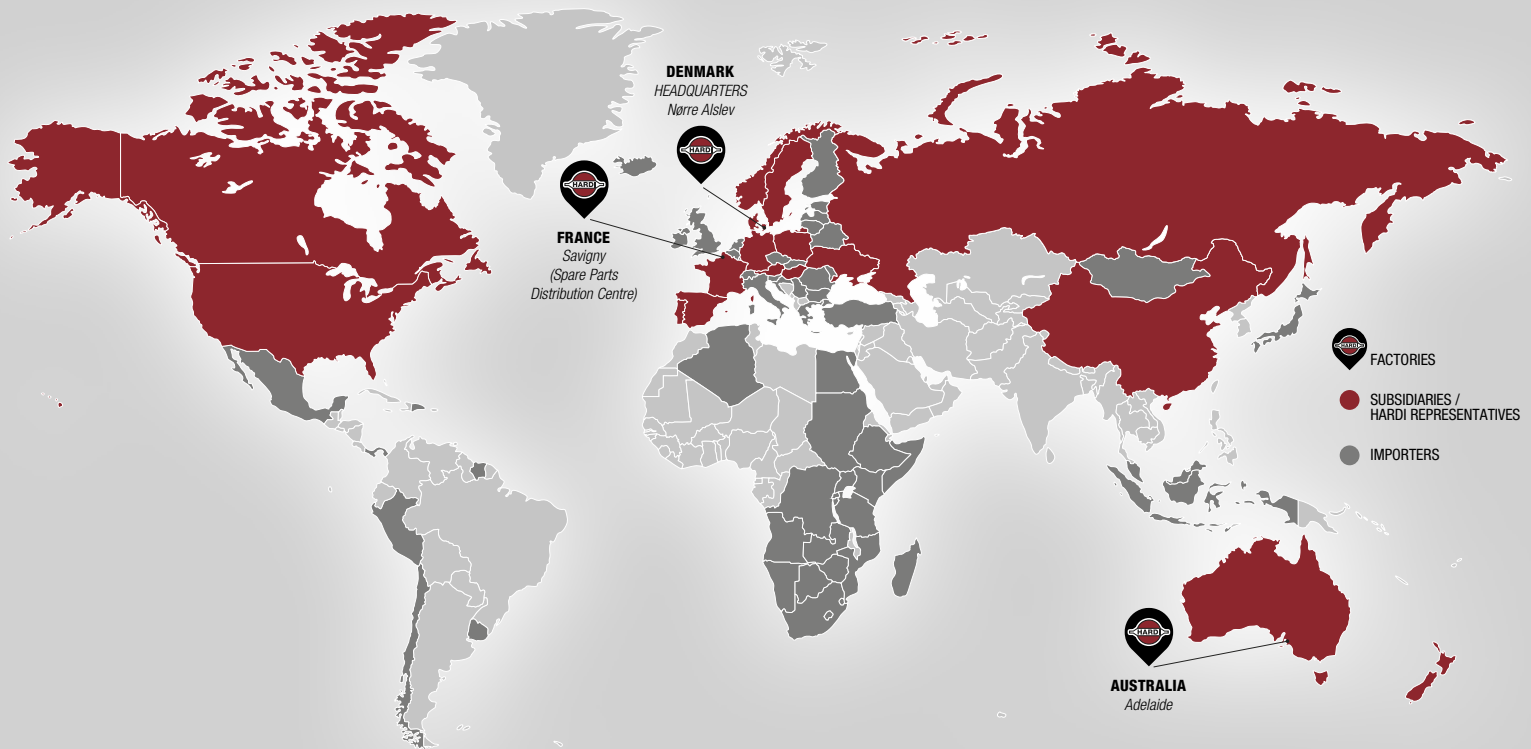

**HARDI INTERNATIONAL A/S**

With over 60 years' experience behind us, HARDI INTERNATIONAL A/S remains a global trendsetter for application of crop protection products. Headquartered in Denmark, we are present in more than 100 countries through a network of subsidiaries, agents and importers.

HARDI INTERNATIONAL A/S is known for the quality, design and performance of our machines. By always putting the customer at the centre of our innovative solutions, we strive to shape the future in plant protection. Our increasingly intelligent products are capable of delivering exact doses and targeted applications with minimal drift and waste – to the benefit of the farmer and the environment.

We believe in a future where our products will be able to take care of plants one by one.



HARDI reserves the right to change the specifications without notice. Illustrations shown may include optional extras and accessories.



**HARDI INTERNATIONAL A/S**

Herthadalvej 10 · 4840 Nørre Alslev · Denmark · Tel: +45 54 46 48 00 · Fax: +45 54 46 48 12  
 Email: info@hardi.com · www.hardi.com